

Fundraising Achievements of the MFHS P&C Association

Over recent years, the P&C have raised money to provide valuable resources and make significant improvements to our school to support the education and wellbeing of our children.

In previous years the P&C have provided funding for...

- * New seating
- * Air conditioning in the Library classroom
- * Air conditioning in the Uniform Shop
- * Water stations and Bottle Filters
- * Large fan in school Hall
- * Year 7 Scholarships
- * Sports Scholarships
- * Year 12 Gifts
- * Manga High (Mathematics Program)
- * Education Perfect (Languages Program)

The P&C also represents the community on numerous merit selection panels.

School Uniform Shop

Our school image is enhanced both within school and in the local community by students wearing a school uniform.

It establishes school identity and belonging, along with representing our school values or respect, pride and safety.

All items of the school uniform (except shoes and socks) can be purchased at school from our Uniform Shop.

Second hand uniforms can also be purchased.

Location:

The uniform shop is located near the Bus Bay, next to the Canteen off Redmond Avenue.



Opening Times

Monday 7:45am - 9:15am (*Terms 1 & 4 only*)

Tuesday 2:00pm - 3:30pm

Friday 7:45am - 9:15am

Tuesday Lunchtime for Students Only.

Online Uniform Shop:

www.munchmonitor.com

School ID: modelfarmsuniform

Password: munch2153

Should you have any queries, please contact us at mfhspandc.uniformshop@gmail.com

Model Farms High School P&C Association Incorporated

P&C stands for 'Parents & Citizens' Association. A P&C Association is a school-based organization consisting of parents, teachers and interested citizens.

The P&C's role is to provide a forum in which parents can develop their partnership with the school and articulate their aspirations for their children's education.



Who leads the P&C?

Each year the P&C holds regular meetings, as well as an Annual General Meeting.

One of the important functions of an Annual General Meeting is to elect the P&C Executive Committee - volunteer parents who are willing to take leadership positions for the P&C.

The Executive for our P&C consists of the President, two Vice-Presidents, the Secretary and the Treasurer.

There are also other leadership positions associated with the uniform shop and coordinating events.

What does the P&C do?

Promotes a positive learning and social environment.

Acts as a liaison between the school and parents.

Represents parents and provides support and advice to the Principal and Executive team.

Offering a forum for cooperation between students, teachers and the community.

Assisting with the provision of resources, facilities and equipment for the school.

Encouraging parents and caregiver participation in education issues.

Promoting public education and acts on broader educational issues & community issues.

Why join the MFHS P&C?

Participating in your child's education helps student engagement and learning.

This forum will keep you informed of key school events and issues.

The P&C enables you to advocate for issues important to you and your child.

Meetings are a great avenue to network with other parents.

Some meetings will have guest speakers and topical information sessions.

Your opinion is valued in decision making about school activities.



How can I be involved?

Unless otherwise advised, the P&C meets in the Staff Common Room in the Block 5 (Administration block) at 7pm on the first Wednesday of the month, during school terms.

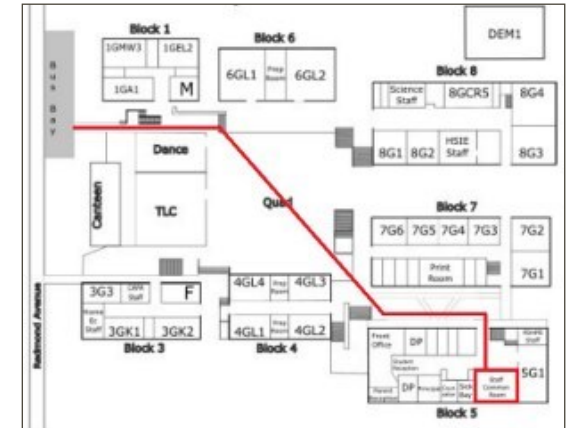

Meetings generally go for an hour. You are welcome to attend on a one-off basis or as a regular participant.

Contact Us

All general enquiries, comments, questions and suggestions can be directed to Model Farms High School P&C Association Executives via email: mfhspandc@gmail.com or contact us via the school office

